

P/N 62-801MP M/C

Depth Gauge Instructions

STEP 1

- i) Insert the round pin end into the Master Cylinder's Primary Piston as shown on the Tool.

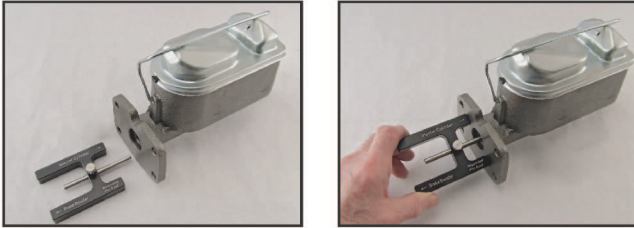

- ii) Move the gauge from left to right to center the round pin end into the Piston.
iii) Tighten down the Thumb Screw

STEP 2

- i) Turn the Tool around with the inscribed arrow "Brake Booster" facing you.
ii) Rest the flat pin end on the Brake Booster to determine the height of the Push Rod.

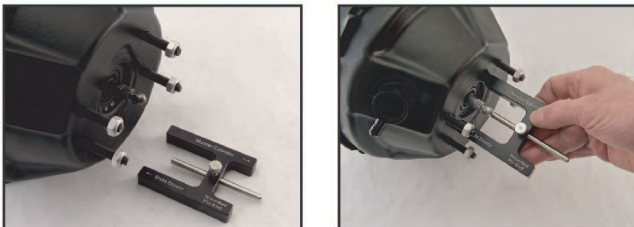

STEP 3

- i) Increase or decrease the length of the Adjusting Acorn Nut either up or down depending on gauge pin stop point.



- ii) You must have an "Air Gap" between the gauge tool pin and the Booster's Master Cylinder's Push Rod.

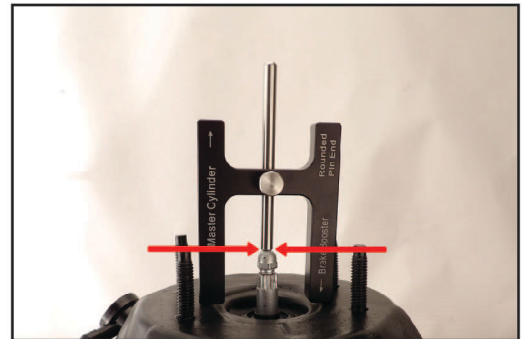

- iii) It may be necessary to remove the Brake Boosters Push Rod from the Unit and place in a vise to loosen the Adjusting Acorn Nut
iv) Clean and lightly grease. Use only synthetic grease on the threads of the Adjusting Acorn Nut and readjust.

STEP 4

- i) When all of the above is completed, install the Master Cylinder to the Power Brake Booster

TOOLS ARE NOT ELIGIBLE FOR RETURN